

UNIVERSAL HEAD DRIVE PIN RIVETS															
Part Number	D Shank Diameter (± .001)	L Length (+.010, -.005)	Grip Range		R Head Diameter (+.005, -.015)	H Head Height (± .005)	Part Number	D Shank Diameter (± .001)	L Length (+.010, -.005)	Grip Range		R Head Diameter (+.005, -.015)	H Head Height (± .005)		
			Min	Max						Min	Max				
			05031AUSS	.125						.156	.015			.046	.250
05063AUSS	.156	.046	.078		10500AUA	.656	.453	.547							
05094AUSS	.188	.078	.109		10563AUA	.719	.516	.609							
05125AUA	.219	.109	.141		10625AUA	.781	.578	.672							
05156AUA	.250	.141	.172		10688AUA	.844	.641	.734							
05188AUA	.281	.172	.203		10750AUA	.906	.703	.797							
05219AUA	.313	.203	.234		10813AUA	.969	.766	.859							
05250AUA	.344	.234	.266		10875AUA	1.031	.828	.922							
05281AUA	.375	.266	.297		101000AUA	1.156	.953	1.047							
05313AUA	.406	.297	.328		101125AUA	1.281	1.078	1.172							
05344AUA	.438	.328	.359		14094AUA	.250	.047	.141	.500	.107					
05375AUA	.469	.359	.391		14125AUA	.281	.078	.172							
05406AUA	.500	.391	.422		14188AUA	.344	.141	.234							
05438AUSS	.531	.422	.453		14250AUA	.406	.203	.297							
07031AUSS	.156	.188	.015		.046	14313AUA	.469	.266			.359				
07063AUSS		.188	.046	.078	14375AUA	.531	.328	.422							
07094AUSS		.219	.078	.109	14438AUA	.594	.391	.484							
07125AUA		.250	.109	.141	14500AUA	.656	.453	.547							
07156AUA		.281	.141	.172	14563AUA	.719	.516	.609							
07188AUA		.313	.172	.203	14625AUA	.781	.578	.672							
07219AUA		.344	.203	.234	14688AUA	.844	.641	.734							
07250AUA		.375	.234	.266	14750AUA	.906	.703	.797							
07281AUA		.406	.266	.297	14813AUA	.969	.766	.859							
07313AUA		.438	.297	.328	14875AUA	1.031	.828	.922							
07344AUA		.469	.328	.359	14938AUA	1.094	.891	.984							
07406AUA		.531	.391	.422	141000AUA	1.156	.953	1.047							
07438AUSS		.563	.422	.453	141125AUA	1.281	1.078	1.172							
07500AUSS		.625	.484	.515	141375AUA	1.531	1.328	1.422							
07531AUSS		.656	.515	.546	31188AUA	.313	.438	.132	.242	.625	.138				
07563AUSS		.688	.546	.578	31281AUA		.531	.226	.336						
07625AUSS		.750	.609	.640	31375AUA		.625	.320	.430						
All sizes in gray-shaded area have stainless steel pins.							31469AUA	.719	.414			.523			
10094AUA		.187	.250	.047	.141		31563AUA	.813	.508			.617			
10125AUA			.281	.078	.172	37188AUA	.375	.500	.125	.250	.750	.166			
10188AUA			.344	.141	.234	37281AUA		.594	.219	.344					
10250AUA	.406		.203	.297	37375AUA	.688		.313	.438						
10313AUA	.469		.266	.359	37469AUA	.781		.406	.531						
10375AUA	.531		.328	.422	37563AUA	.875		.500	.625						

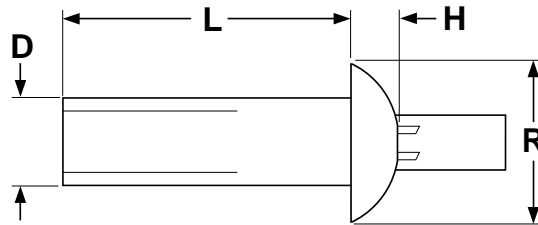

Description	<p>A two-piece fastening system consisting of (1) a self-contained pin within (2) the body of a tubular-shaped rivet with a dome-shaped head. The head is approximately twice as wide as the shank diameter. The top of the rivet has an opening through which the pin protrudes. The opposite end of the rivet is enclosed but with two cross-wise slits cut into the body extending from the tip, up the shank a limited distance.</p>	
Applications/ Advantages	<p>Drive pin rivets can join two or more pieces of low-density metal without the use of special installation tools. The rivet is inserted into pre-drilled, aligned holes and is set in place by striking the top of the pin with a hammer so that the pin is flush with the top of the head. This action causes the pin to drive through the opposite end and flare out in four directions creating a head on the blind side of the fastening. Drive pins have superior shear strength to standard break stem rivets because the pin remains inside of the installed rivet for its entire length. The universal head is the most versatile variety of drive pin, giving the neat, finished look of the brazier but with a lower head profile.</p>	
Material	<i>Aluminum Body</i>	<i>Steel Body</i>
	<p>Body: Aluminum alloy 2117 H15 or equivalent alloy Pin (1/8 & 5/32 diam): 302 series Stainless Steel Pin (3/16 thru 3/8 diam): Aluminum alloy 2024 T4 or equivalent alloy</p>	<p>Body: AISI 1006 - 1008 or equivalent steel, zinc-plated Pin: AISI 1008 or equivalent steel, zinc-plated</p>
Shear Strength (approximate)	<p>1/8" diameter: 480 lbs. (w/Stainless pin) 5/32" diameter: 715 lbs. (w/Stainless pin) 3/16" diameter: 700 lbs. (w/Aluminum pin) 1/4" diameter: 1030 lbs. (w/Aluminum pin) 5/16" diameter: 1490 lbs. (w/Aluminum pin) 3/8" diameter: 2300 lbs. (w/Aluminum pin)</p>	<p>3/8" diameter: 3000 lbs. (w/Steel pin)</p>
Tensile Strength (approximate)	<p>1/8" diameter: 175 lbs. (w/Stainless pin) 5/32" diameter: 310 lbs. (w/Stainless pin) 3/16" diameter: 360 lbs. (w/Aluminum pin) 1/4" diameter: 815 lbs. (w/Aluminum pin) 5/16" diameter: 1480 lbs. (w/Aluminum pin) 3/8" diameter: 1795 lbs. (w/Aluminum pin)</p>	<p>3/8" diameter: 2500 lbs. (w/Steel pin)</p>