

Phillips & Square Drive

Trim Head Drywall Screws

Self-Tapping Screws

Phillips Drive Trim Head

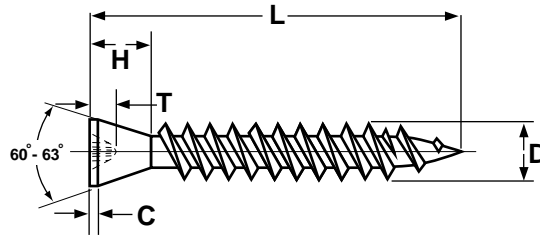
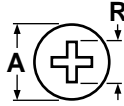

Square Drive Trim Head

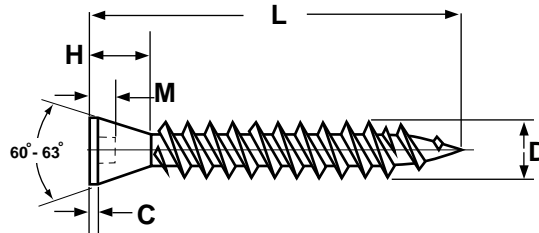
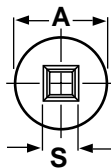

| TRIM HEAD DRYWALL SCREWS | | | | | | | | | | | | | | | | | |
|---------------------------------|---------------|------|--------------------------|------|-----------------------|------|---------------|------|---------------------|--------|----------------|------|-----------------|------|-------------|------|------------|
| Nominal Size & Threads per Inch | A | | R | | T | | S | | M | | C | | D | | H | | Drive Size |
| | Head Diameter | | Phillips Recess Diameter | | Phillips Recess Depth | | Recess Square | | Square Recess Depth | | Head Thickness | | Thread Diameter | | Head Height | | |
| | Max | Min | Max | Min | Max | Min | Max | Min | Max | Min | Max | Min | Max | Min | Max | Min | |
| 6 - 18 | .236 | .216 | .154 | .141 | .075 | .051 | .106 | .091 | .071 | .055 | .031 | .023 | .142 | .133 | .150 | .133 | #1 |
| 8 - 15 | .276 | .256 | .185 | .169 | .104 | .080 | .113 | .110 | .075 | .065 | .031 | .023 | .169 | .161 | .150 | .133 | #2 |
| Tolerance on Length | | | | | | | | | | ± 0.06 | | | | | | | |

| | |
|--------------------------|--|
| Description | A screw with twinfast thread, extra sharp point and countersunk flat head of a width 1/3 less than a standard bugle drywall screws. |
| Applications/ Advantages | For attaching wood trim to wood framing of up to 20 gage thick. The square drive variety is preferred when greater torque is required during installation. |
| Material | AISI 1018 or equivalent steel |
| Heat Treatment | Screws shall be quenched in liquid and then tempered by reheating to 650°F minimum. |
| Case Depth | .004 in. minimum |
| Surface Hardness | Vickers HV 550 - 800 (Rockwell C 52.3 - 64) |
| Core Hardness | HV 270 - 450 (Rockwell C 25.6 - 45.3) |
| Plating | Black phosphate finish |